

REPORT OF GROUP DIRECTOR, NEIGHBOURHOODS AND HOUSING		
LICENSING SUB-COMMITTEE: 14/04/2020	Classification DECISION	Enclosure
Application for a Premises Licence Fanny's Kebabs, Basement and Ground Floor, 92 Stoke Newington High Street, London, N167NY	Ward(s) affected Stoke Newington	

1. SUMMARY

Applicant(s) Mr Jacek Bilinski	In SPA: Not applicable
Date of Application 21/02/2020	Period of Application Permanent
Proposed licensable activity	
Plays Films Live Music Recorded Music Performance of Dance Other Entertainment Similar to Live or Rec Music or Dance Performance Late Night Refreshment Supply of Alcohol (On Premises)	
Proposed hours of licensable activities	
Plays	Standard Hours:
Indoors	Mon 10:00-23:45 Tue 10:00-23:45 Wed 10:00-23:45 Thu 10:00-23:45 Fri 10:00-23:45 Sat 10:00-23:45 Sun 10:00-23:45
Films	Standard Hours:
Indoors	Mon 10:00-23:45 Tue 10:00-23:45 Wed 10:00-23:45 Thu 10:00-23:45 Fri 10:00-23:45 Sat 10:00-23:45 Sun 10:00-23:45

<p>Live Music</p> <p>Indoors</p>	<p>Standard Hours:</p> <p>Mon 10:00-23:45 Tue 10:00-23:45 Wed 10:00-23:45 Thu 10:00-01:00 Fri 10:00-01:30 Sat 10:00-01:30 Sun 10:00-23:45</p>
<p>Recorded Music</p> <p>Indoors</p>	<p>Standard Hours:</p> <p>Mon 10:00-23:45 Tue 10:00-23:45 Wed 10:00-23:45 Thu 10:00-01:00 Fri 10:00-01:30 Sat 10:00-01:30 Sun 10:00-23:45</p>
<p>Performance of Dance</p> <p>Indoors</p>	<p>Standard Hours:</p> <p>Mon 10:00-23:45 Tue 10:00-23:45 Wed 10:00-23:45 Thu 10:00-01:00 Fri 10:00-01:30 Sat 10:00-01:30 Sun 10:00-23:45</p>
<p>Other Entertainment Similar to Live or Rec Music or Dance Performance</p> <p>Indoors</p>	<p>Standard Hours:</p> <p>Mon 10:00-23:45 Tue 10:00-23:45 Wed 10:00-23:45 Thu 10:00-01:00 Fri 10:00-01:30 Sat 10:00-01:30 Sun 10:00-23:45</p>
<p>Late Night Refreshment</p> <p>Indoors</p>	<p>Standard Hours:</p> <p>Mon 10:00-23:45 Tue 10:00-23:45 Wed 10:00-23:45 Thu 10:00-00:30 Fri 10:00-01:00 Sat 10:00-01:00 Sun 10:00-23:45</p>
<p>Supply of Alcohol</p>	<p>Standard Hours:</p> <p>Mon 10:00-23:45 Tue 10:00-23:45 Wed 10:00-23:45 Thu 10:00-01:00</p>

Fri 10:00-01:30 Sat 10:00-01:30 Sun 10:00-23:45	
The opening hours of the premises Standard Hours: Mon 10:00-00:00 Tue 10:00-00:00 Wed 10:00-00:00 Thu 10:00-01:00 Fri 10:00-01:30 Sat 10:00-01:30 Sun 10:00-00:00	
Capacity: Not known	
Policies Applicable	LP1 (General Principles), LP2 (Licensing Objectives), LP3 (Core Hours) and LP11 (Cumulative Impact - General)
List of Appendices	A – Application for a premises licence and supporting documents B – Representations from responsible authorities C – Current Licence D – Location map
Relevant Representations	<ul style="list-style-type: none"> • Police

2. APPLICATION

2.1 Mr Jacek Bilinski has made an application for a premises licence under the Licensing Act 2003:

- To authorise the supply alcohol for consumption on the premises
- Regulated entertainment
- Late night refreshment

2.2 The application is attached as Appendix A. The applicant has proposed measures that could be converted to conditions (see paragraph 8.1 below).

3. CURRENT STATUS / HISTORY

3.1 The premises have been licensed since November 2017 to authorise the supply alcohol for consumption on and off the premises, regulated entertainment and late night refreshment. The licence was transferred to the current licensee in December 2017 (attached as Appendix C)

3.2 A Temporary Event Notice was given for an event in current year at this premises as follows:

<u>Date</u>	<u>Time</u>
01/01/2020	00:01 to 04:00
26/01/2020	00:01 to 04:00
16/02/2020-17/02/2020	00:01 to 03:00
14/03/2020-15/03/2020	00:01 to 04:00
21/03/2020-22/03/2020	00:01 to 04:00

4. REPRESENTATIONS: RESPONSIBLE AUTHORITIES

From	Details
Environmental Health Authority (Environmental Protection)	No representation received
Environmental Health Authority (Environmental Enforcement)	Have confirmed no representation on this application
Environmental Health Authority (Health & Safety)	No representation received
Weights and Measures (Trading Standards)	Have confirmed no representation on this application
Planning Authority	No representation received
Area Child Protection Officer	No representation received
Fire Authority	Have confirmed no representation on this application
Police (Appendix B)	Representation received on the grounds of The Prevention of Crime and Disorder, Public Safety, Prevention of Public Nuisance and Core Hours.
Licensing Authority	No representation received
Health Authority	No representation received

5. REPRESENTATIONS: OTHER PERSONS

None.

6. GUIDANCE CONSIDERATIONS

- 6.1 The Licensing Authority is required to have regard to any guidance issued by the Secretary of State under the Licensing Act 2003.

7. POLICY CONSIDERATIONS

- 7.1 Licensing Sub-Committee is required to have regard to the London Borough of Hackney's Statement of Licensing Policy ("the Policy") adopted by the Licensing Authority.
- 7.2 The Policy applies to applications where relevant representations have been made. With regard to this application, policies, LP1 (General Principles), LP2 (Licensing Objectives), LP3 (Core Hours) and LP11 (Cumulative Impact - General) are relevant.

8. OFFICER OBSERVATIONS

- 8.1 If the Sub-Committee is minded to approve the application, the following conditions should be applied the licence:

Supply Of Alcohol (On/Both)

Supply of Alcohol

1. No supply of alcohol may be made under the premises licence:
 - (a) At a time when there is no designated premises supervisor in respect of the premises licence.
 - (b) At a time when the designated premises supervisor does not hold a personal licence or his personal licence is suspended.
2. Every supply of alcohol under the premises licence must be made or authorised by a person who holds a personal licence.
3.
 - (1) The responsible person must ensure that staff on relevant premises do not carry out, arrange or participate in any irresponsible promotions in relation to the premises.
 - (2) In this paragraph, an irresponsible promotion means any one or more of the following activities, or substantially similar activities, carried on for the purpose of encouraging the sale or supply of alcohol for consumption on the premises -
 - (a) games or other activities which require or encourage, or are designed to require or encourage, individuals to;
 - (i) drink a quantity of alcohol within a time limit (other than to drink alcohol sold or supplied on the premises before the cessation of the period in which the responsible person is authorised to sell or supply alcohol), or
 - (ii) drink as much alcohol as possible (whether within a time limit or otherwise);
 - (b) provision of unlimited or unspecified quantities of alcohol free or for a fixed or discounted fee to the public or to a group defined by a particular characteristic in a manner which carries a significant risk of undermining a licensing objective;
 - (c) provision of free or discounted alcohol or any other thing as a prize to encourage or reward the purchase and consumption of alcohol over a period of 24 hours or less in a manner which carries a significant risk of undermining a licensing objective;
 - (d) selling or supplying alcohol in association with promotional posters or flyers on, or in the vicinity of, the premises which can reasonably be considered to condone, encourage or glamorise anti-social behaviour or to refer to the effects of drunkenness in any favourable manner.
 - (e) dispensing alcohol directly by one person into the mouth of another (other than where that other person is unable to drink without assistance by reason of a disability).
4. The responsible person must ensure that free potable water is provided on request to customers where it is reasonably available.

5. 5.1. The premises licence holder or club premises certificate holder must ensure that an age verification policy is adopted in respect of the premises in relation to the sales or supply of alcohol.
- 5.2. The designated premises supervisor in relation to the premises licences must ensure that the supply of alcohol at the premises is carried on in accordance with the age verification policy.
- 5.3. The policy must require individuals who appear to the responsible person to be under 18 years of age (or such older age as may be specified in the policy) to produce on request, before being served alcohol, identification bearing their photograph, date of birth and either:-
- (a) a holographic mark or
 - (b) an ultraviolet feature
6. The responsible person must ensure that:
- a) where any of the following alcoholic drinks is sold or supplied for consumption on the premises (other than alcoholic drinks sold or supplied having been made up in advance ready for sale or supply in a securely closed container) it is available to customers in the following measures:
 - beer or cider: 1/2 pint;
 - gin, rum, vodka or whisky: 25ml or 35ml; and
 - still wine in a glass: 125ml; and
 - b) these measures are displayed in a menu, price list or other printed material which is available to customers on the premises; and
 - c) where a customer does not in relation to a sale of alcohol specify the quantity of alcohol to be sold, the customer is made aware that these measures are available.

Minimum Drinks Pricing

7. 7.1 A relevant person shall ensure that no alcohol is sold or supplied for consumption on or off the premises for a price which is less than the permitted price.
- 7.2. For the purposes of the condition set out in paragraph 7.1 above -
- (a) "duty" is to be construed in accordance with the Alcoholic Liquor Duties Act 1979;
 - (b) "permitted price" is the price found by applying the formula - $P = D + (D \times V)$
Where -
 - (i) P is the permitted price,
 - (ii) D is the rate of duty chargeable in relation to the alcohol as if the duty were charged on the date of the sale or supply of the alcohol, and
 - (iii) V is the rate of value added tax chargeable in relation to the alcohol as if the value added tax were charged on the date of the sale or supply of the alcohol;
 - (c) "relevant person" means, in relation to premises in respect of which there is in force a premises licence -

- (i) the holder of the premises licence,
- (ii) the designated premises supervisor (if any) in respect of such a licence, or
- (iii) the personal licence holder who makes or authorises a supply of alcohol under such a licence;
- (d) "relevant person" means, in relation to premises in respect of which there is in force a club premises certificate, any member or officer of the club present on the premises in a capacity which enables the member or officer to prevent the supply in question; and
- (e) "value added tax" means value added tax charged in accordance with the Value Added Tax Act 1994.

7.3 Where the permitted price given by Paragraph 7.2(b) above would (apart from this paragraph) not be a whole number of pennies, the price given by that sub-paragraph shall be taken to be the price actually given by that sub-paragraph rounded up to the nearest penny.

7.4 (1) Sub-paragraph 7.4(2) below applies where the permitted price given by Paragraph 7.2(b) above on a day ("the first day") would be different from the permitted price on the next day ("the second day") as a result of a change to the rate of duty or value added tax.

(2) The permitted price which would apply on the first day applies to sales or supplies of alcohol which take place before the expiry of the period of 14 days beginning on the second day.

Exhibition Of Films

8. Admission of children (under 18) to the exhibition of any film must be restricted in accordance with: -
- (a) Recommendations made by the film classification body where the film classification body is specified in the licence, or
 - (b) Recommendations made by the licensing authority where the film classification body is not specified in the licence, or the relevant licensing authority has not notified the holder of the licence that this subsection applies to the film in question.

"film classification body" means person('s) designated under s4 of the Video Recordings Act 1984(c.39).

Door Supervision

9. Each individual who is to carry out a security activity at the premises must be licensed by the Security Industry Authority.

Conditions derived from operating schedule

10. Any incidents of a criminal nature that may occur on the premises will be reported to the Police.
11. The Licensee will install comprehensive CCTV coverage at the premises and it is operated and maintained at the premises. The CCTV system shall conform to the following points:

- a. Cameras must be sited to observe the entrance and exit doors both inside and outside.
 - b. Cameras on the entrances must capture full frame shots of the heads and shoulders of all people entering the premises i.e. capable of identification.
 - c. Cameras viewing till areas must capture frames not less than 50% of screen.
 - d. Cameras overlooking floor areas should be wide angled to give an overview of the premises.
 - e. Be capable of visually confirming the nature of the crime committed.
 - f. Provide a linked record of the date, time and place of any image.
 - g. Provide good quality images –colour during opening times.
 - h. Operate under existing light levels within and outside the premises.
 - i. Have the recording device located in a secure area or locked cabinet.
 - j. Have a monitor to review images and recorded picture quality.
 - k. Be regularly maintained to ensure continuous quality of image capture retention.
 - l. Have signage displayed in the customer area to advise that CCTV is in operation.
 - m. Digital images must be kept for 31 days.
 - n. Police will have access to images at any reasonable time.
 - o. The equipment must have a suitable export method, e. G. CD/DVD writer so that the police can make an evidential copy of the data they require. This data should be in the native file format, to ensure that no image quality is lost when making the copy, if this format is non-standard (i.e. manufacturer proprietary) then the manufacturer should supply the replay software to ensure that the video on the CD can be replayed by the police on a standard computer. Copies must be made available to Police on request.
12. All customers will be asked to leave quietly. Clear and legible notices will be prominently displayed to remind customers to leave quietly and have regard to our neighbours.
13. The licensee and staff will ask persons who appear to be under the age of 25 for photographic ID such as proof of age cards, the Connexions Card and Citizen Card, photographic driving licence or passport, an official identity card issued by HM Forces or by an EU country, bearing the photograph and date of birth of bearer. All staff will be trained for underage sales prevention regularly. A register of refused sales shall be kept and maintained on the premises.
14. All emergency exits shall be kept free from obstruction at all times.
15. Appropriate fire safety procedures are in place including fire extinguishers (foam, H2O and CO2), fire blanket, internally illuminated fire exit signs, numerous smoke detectors and emergency lighting .All appliances are inspected annually.

9. REASONS FOR OFFICER OBSERVATIONS

- 9.1 Conditions 10 to 15 above are derived from the applicant's operating schedule.

10. LEGAL COMMENTS

10.1 The Council has a duty as a Licensing Authority under the Licensing Act 2003 to carry out its functions with a view to promoting the following 4 licensing objectives;

- The Prevention of Crime and Disorder
- Public Safety
- Prevention of Public Nuisance
- The Protection of Children from Harm

10.2 It should be noted that each of the licensing objectives have equal importance and are the only grounds upon which a relevant representation can be made and for which an application can be refused or terms and conditions attached to a licence.

11. HUMAN RIGHTS ACT 1998 IMPLICATIONS

11.1 There are implications to;

- **Article 6** – Right to a fair hearing
- **Article 14** – Not to discriminate
- Balancing: **Article 1**- Peaceful enjoyment of their possession (i.e. a licence is defined as being a possession) with **Article 8** – Right of Privacy (i.e. respect private & family life) to achieve a proportionate decision having regard to the protection of an individuals rights against the interests of the community at large.

12. MEMBERS DECISION MAKING

A. Option 1

That the application be refused

B. Option 2

That the application be approved, together with any conditions or restrictions which Members consider necessary for the promotion of the Licensing objectives.

13. CONCLUSION

13.1 That Members decide on the application under the Licensing Act 2003.

Acting Group Director, Neighbourhoods and Housing	Ajman Ali
Lead Officer (holder of original copy):	Shan Uthayasangar Licensing Officer Licensing Service 1 Hillman Street E8 1DY Telephone: 020 8356 2431

LIST OF BACKGROUND PAPERS RELATING TO THIS REPORT

The following document(s) has been relied upon in the preparation of the report.

Description of document	Location
Office File: Fanny's Kebabs, Basement and Ground Floor, 92 Stoke Newington High Street, N16 7NY	Licensing Service 1 Hillman Street London E8 1DY

Printed matter

Licensing Act 2003

LBH Statement of Licensing Policy

Hackney
LA01

Application for a premises licence to be granted under the Licensing Act 2003

PLEASE READ THE FOLLOWING INSTRUCTIONS FIRST

Before completing this form please read the guidance notes at the end of the form. If you are completing this form by hand please write legibly in block capitals. In all cases ensure that your answers are inside the boxes and written in black ink. Use additional sheets if necessary.

You may wish to keep a copy of the completed form for your records.

I/We Mr JACEK BILINSKI

(Insert name(s) of applicant)

apply for a premises licence under section 17 of the Licensing Act 2003 for the premises described in Part 1 below (the premises) and I/we are making this application to you as the relevant licensing authority in accordance with section 12 of the Licensing Act 2003

Part 1 – Premises details

Postal address of premises or, if none, ordnance survey map reference or description FANNY'S KEBABS BASEMENT AND GROUND FLOOR 92 STOKE NEWINGTON HIGH STREET HACKNEY LONDON			
Post town	LONDON	Postcode	N16 7NY

Telephone number at premises (if any)	[REDACTED]
Non-domestic rateable value of premises	£32000

Part 2 - Applicant details

Please state whether you are applying for a premises licence as **appropriate** **Please tick as**

a)	an individual or individuals *	<input checked="" type="checkbox"/>	please complete section (A)
b)	a person other than an individual *		
i.	as a limited company/limited liability partnership	<input type="checkbox"/>	please complete section (B)

	ii.	as a partnership (other than limited liability)	<input type="checkbox"/>	please complete section (B)
	iii.	as an unincorporated association or	<input type="checkbox"/>	please complete section (B)
	iv.	other (for example a statutory corporation)	<input type="checkbox"/>	please complete section (B)
c)		a recognised club	<input type="checkbox"/>	please complete section (B)
d)		a charity	<input type="checkbox"/>	please complete section (B)
e)		the proprietor of an educational establishment	<input type="checkbox"/>	please complete section (B)
f)		a health service body	<input type="checkbox"/>	please complete section (B)
g)		a person who is registered under Part 2 of the Care Standards Act 2000 (c14) in respect of an independent hospital in Wales	<input type="checkbox"/>	please complete section (B)
ga)		a person who is registered under Chapter 2 of Part 1 of the Health and Social Care Act 2008 (within the meaning of that Part) in an independent hospital in England	<input type="checkbox"/>	please complete section (B)
h)		the chief officer of police of a police force in England and Wales	<input type="checkbox"/>	please complete section (B)

* If you are applying as a person described in (a) or (b) please confirm (by ticking yes to one box below):

- I am carrying on or proposing to carry on a business which involves the use of the premises for licensable activities; or



- I am making the application pursuant to a
 - statutory function or
 - a function discharged by virtue of Her Majesty's prerogative

(A) INDIVIDUAL APPLICANTS (fill in as applicable)

Title Mr			
Surname BILINSKI		First names JACEK	
I am 18 years old or over			<input checked="" type="checkbox"/>
Date of birth ██████████			
Nationality ██████████			
Current residential address if different from premises address		██████████ ██████████	
Post town	██████████	Postcode	██████████
Daytime contact telephone number		██████████	
E-mail address (optional)	██		
Where applicable (if demonstrating a right to work via the Home Office online right to work checking service), the 9-digit 'share code' provided to the applicant by that service (please see note 15 for information)			

SECOND INDIVIDUAL APPLICANT (if applicable)

Title Mr			
Surname		First names	
I am 18 years old or over			.. Please tick yes

Date of birth			
Nationality			
Current postal address if different from premises address		UK-England	
Post town		Postcode	
Daytime contact telephone number			
E-mail address (optional)			
Where applicable (if demonstrating a right to work via the Home Office online right to work checking service), the 9-digit 'share code' provided to the applicant by that service (please see note 15 for information)			

(B) OTHER APPLICANTS

Please provide name and registered address of applicant in full. Where appropriate please give any registered number. In the case of a partnership or other joint venture (other than a body corporate), please give the name and address of each party concerned.

Name
Address
UK-England
Registered number (where applicable)
Description of applicant (for example, partnership, company, unincorporated association etc.)
Telephone number (if any)

E-mail address (optional)

Part 3 Operating Schedule

When do you want the premises licence to start?

DD MM YYYY

31-03-2020

If you wish the licence to be valid only for a limited period, when do you want it to end?

DD MM YYYY

Please give a general description of the premises (please read guidance note 1)

The ground floor is a quick service restaurant serving up healthy kebabs in wraps, rice boxes and salad boxes. The decor is based around a California/Miami feel with circa 28 covers. We operate both an eat-in and take away service. Customers are also able to have the opportunity to buy soft drinks, local beers and hand-picked wines upstairs.

The basement bar is open Tues-Sat and has a more sophisticated decor than the ground floor with lower lighting, lounge seating with a brass topped bar. Downstairs customers are able to order food from the upstairs menu and also order cocktails from the bar. The space hosts local music artists on a regular basis playing original music, spoken word events as well as DJ's in the later part of the evening. The space is also used as a rehearsal space for music artists during the day.

If 5,000 or more people are expected to attend the premises at any one time, please state the number expected to attend.

N/A

What licensable activities do you intend to carry on from the premises?

(Please see sections 1 and 14 and Schedules 1 and 2 to the Licensing Act 2003)

	Provision of regulated entertainment (please read guidance note 2)	Please tick all that apply
a)	plays (if ticking yes, fill in box A)	<input checked="" type="checkbox"/>
b)	films (if ticking yes, fill in box B)	<input checked="" type="checkbox"/>
c)	indoor sporting events (optional, fill in box C)	..
d)	boxing or wrestling entertainment (if ticking yes, fill in box D)	..
e)	live music (optional, fill in box E)	<input checked="" type="checkbox"/>
f)	recorded music (if ticking yes, fill in box F)	<input checked="" type="checkbox"/>
g)	performances of dance (optional, fill in box G)	<input checked="" type="checkbox"/>
h)	anything of a similar description to that falling within (e), (f) or (g) (if ticking yes, fill in box H)	<input checked="" type="checkbox"/>

Provision of late night refreshment (if ticking yes, fill in box I)



Supply of alcohol (if ticking yes, fill in box J)



In all cases complete boxes K, L and M

A

Plays Standard days and timings (please read guidance note 7)			Will the performance of a play take place indoors or outdoors or both – please tick (please read guidance note 3)	Indoors	<input checked="" type="checkbox"/>
				Outdoors	
				Both	
Day	Start	Finish	Please give further details here (please read guidance note 4)		
Mon	10:00	23:45			
Tue	10:00	23:45	State any seasonal variations for performing plays (please read guidance note 5)		
Wed	10:00	23:45			
Thur	10:00	23:45	Non-standard timings. Where you intend to use the premises for the performance of plays at different times to those listed in the column on the left, please list (please read guidance note 6)		
Fri	10:00	23:45			
Sat	10:00	23:45			
Sun	10:00	23:45			

B

Films Standard days and timings (please read guidance note 7)			Will the exhibition of films take place indoors or outdoors or both – please tick (please read guidance note 3)	Indoors	<input checked="" type="checkbox"/>
				Outdoors	
Day	Start	Finish		Both	
Mon	10:00	23:45	Please give further details here (please read guidance note 4)		
Tue	10:00	23:45			
Wed	10:00	23:45	State any seasonal variations for the exhibition of films (please read guidance note 5)		
Thur	10:00	23:45			
Fri	10:00	23:45	Non-standard timings. Where you intend to use the premises for the exhibition of films at different times to those listed in the column on the left, please list (please read guidance note 6)		
Sat	10:00	23:45			
Sun	10:00	23:45			

C

Indoor sporting events Standard days and timings (please read guidance note 7)			Please give further details (please read guidance note 4)
Day	Start	Finish	
Mon			State any seasonal variations for indoor sporting events (please read guidance note 5)
	-----	-----	
Tue			Non-standard timings. Where you intend to use the premises for indoor sporting events at different times to those listed in the column on the left, please list (please read guidance note 6)
	-----	-----	
Wed			
	-----	-----	
Thur			
	-----	-----	
Fri			
	-----	-----	
Sat			
	-----	-----	
Sun			
	-----	-----	

D

Boxing or wrestling entertainments Standard days and timings (please read guidance note 7)			Will the boxing or wrestling entertainment take place indoors or outdoors or both – please tick (please read guidance note 3)		Indoors	
					Outdoors	
Day	Start	Finish			Both	
Mon			Please give further details here (please read guidance note 4)			
Tue			State any seasonal variations for boxing or wrestling entertainment (please read guidance note 5)			
Wed			Non-standard timings. Where you intend to use the premises for boxing or wrestling entertainment at different times to those listed in the column on the left, please list (please read guidance note 6)			
Thur						
Fri						
Sat						
Sun						

E

Live music Standard days and timings (please read guidance note 7)			Will the performance of live music take place indoors or outdoors or both – please tick (please read guidance note 3)	Indoors	<input checked="" type="checkbox"/>
				Outdoors	<input type="checkbox"/>
				Both	<input type="checkbox"/>
Day	Start	Finish	Please give further details here (please read guidance note 4)		
Mon	10:00	23:45			
	-----	-----			
Tue	10:00	23:45			
	-----	-----	State any seasonal variations for the performance of live music (please read guidance note 5)		
Wed	10:00	23:45			
	-----	-----			
Thur	10:00	00:00			
	-----	-----	Non-standard timings. Where you intend to use the premises for the performance of live music at different times to those listed in the column on the left, please list (please read guidance note 6)		
	00:00	01:00			
	-----	-----			
Fri	10:00	00:00			
	-----	-----			
	00:00	01:30			
	-----	-----			
Sat	10:00	00:00			
	-----	-----			
	00:00	01:30			
	-----	-----			
Sun	10:00	23:45			
	-----	-----			

F

Recorded music Standard days and timings (please read guidance note 7)			Will the playing of recorded music take place indoors or outdoors or both – please tick (please read guidance note 3)	Indoors	<input checked="" type="checkbox"/>
				Outdoors	
				Both	
Day	Start	Finish	Please give further details here (please read guidance note 4)		
Mon	10:00	23:45			
	-----	-----			
Tue	10:00	23:45			
	-----	-----	State any seasonal variations for the playing of recorded music (please read guidance note 5)		
Wed	10:00	23:45			
	-----	-----			
Thur	10:00	00:00			
	-----	-----	Non-standard timings. Where you intend to use the premises for the playing of recorded music at different times to those listed in the column on the left, please list (please read guidance note 6)		
Fri	10:00	00:00			
	-----	-----			
	00:00	01:30			
Sat	10:00	00:00			
	-----	-----			
	00:00	01:30			
Sun	10:00	23:45			
	-----	-----			

G

Performances of dance Standard days and timings (please read guidance note 7)			Will the performance of dance take place indoors or outdoors or both – please tick (please read guidance note 3)	Indoors	<input checked="" type="checkbox"/>
Day	Start	Finish		Outdoors	
				Both	
Mon	10:00	23:45	Please give further details here (please read guidance note 4)		
Tue	10:00	23:45	State any seasonal variations for the performance of dance (please read guidance note 5)		
Wed	10:00	23:45	Non-standard timings. Where you intend to use the premises for the performance of dance at different times to those listed in the column on the left, please list (please read guidance note 6)		
Thur	10:00	00:00			
	00:00	01:00			
Fri	10:00	00:00			
	00:00	01:30			
Sat	10:00	00:00			
	00:00	01:30			
Sun	10:00	23:45			

H

Anything of a similar description to that falling within (e), (f) or (g) Standard days and timings (please read guidance note 7)			Please give a description of the type of entertainment you will be providing		
Day	Start	Finish	Will this entertainment take place indoors or outdoors or both – please tick (please read guidance note 3)	Indoors	<input checked="" type="checkbox"/>
Mon	10:00	23:45		Outdoors	<input type="checkbox"/>
				Both	<input type="checkbox"/>
Tue	10:00	23:45	Please give further details here (please read guidance note 4)		
Wed	10:00	23:45			
Thur	10:00	00:00	State any seasonal variations for entertainment of a similar description to that falling within (e), (f) or (g) (please read guidance note 5)		
		00:00			
Fri	10:00	00:00			
		00:00			
Sat	10:00	00:00	Non-standard timings. Where you intend to use the premises for the entertainment of a similar description to that falling within (e), (f) or (g) at different times to those listed in the column on the left, please list (please read guidance note 6)		
		00:00			
Sun	10:00	23:45			

I

Late night refreshment Standard days and timings (please read guidance note 7)			Will the provision of late night refreshment take place indoors or outdoors or both – please tick (please read guidance note 3)	Indoors	<input checked="" type="checkbox"/>
				Outdoors	
Day	Start	Finish		Both	
Mon	23:00	23:45	Please give further details here (please read guidance note 4)		
Tue	23:00	23:45			
Wed	23:00	23:45	State any seasonal variations for the provision of late night refreshment (please read guidance note 5)		
Thur	23:00	00:00			
	00:00	00:30			
Fri	23:00	00:00	Non-standard timings. Where you intend to use the premises for the provision of late night refreshment at different times, to those listed in the column on the left, please list (please read guidance note 6)		
	00:00	01:00			
Sat	23:00	00:00			
	00:00	01:00			
Sun	23:00	23:45			

J

Supply of alcohol Standard days and timings (please read guidance note 7)			Will the supply of alcohol be for consumption – please tick (please read guidance note 8)	On the premises	<input checked="" type="checkbox"/>
				Off the premises	<input type="checkbox"/>
				Both	<input type="checkbox"/>
Day	Start	Finish	State any seasonal variations for the supply of alcohol (please read guidance note 5)		
Mon	10:00	23:45			
Tue	10:00	23:45			
Wed	10:00	23:45			
Thur	10:00	00:00			
	00:00	01:00			
Fri	10:00	00:00			
	00:00	01:30			
Sat	10:00	00:00			
	00:00	01:30			
Sun	10:00	23:45			
			Non-standard timings. Where you intend to use the premises for the supply of alcohol at different times to those listed in the column on the left, please list (please read guidance note 6)		

State the name and details of the individual whom you wish to specify on the licence as designated premises supervisor (Please see declaration about the entitlement to work in the checklist at the end of the form):

Name Mr JACEK BILINSKI	
Date of birth ██████████	
Address ██████████ ██████████ ██████████ d	
Postcode	██████████
Personal licence number (if known) ██████████	
Issuing licensing authority (if known) ██████████	

K

Please highlight any adult entertainment or services, activities, other entertainment or matters ancillary to the use of the premises that may give rise to concern in respect of children (please read guidance note 9).
 THERE WILL BE NO SUCH ACTIVITIES TAKING PLACE ON THE PREMISES.

L

Hours premises are open to the public Standard days and timings (please read guidance note 7)			State any seasonal variations (please read guidance note 5)
Day	Start	Finish	
Mon	10:00	00:00	
Tue	10:00	00:00	
Wed	10:00	00:00	
Thur	10:00	00:00	
	00:00	01:00	
Fri	10:00	00:00	Non-standard timings. Where you intend the premises to be open to the public at different times from those listed in the column on the left, please list (please read guidance note 6)
	00:00	01:30	
Sat	10:00	00:00	
	00:00	01:30	
Sun	10:00	00:00	

M Describe the steps you intend to take to promote the four licensing objectives:

a) General – all four licensing objectives (b, c, d and e) (please read guidance note 10)

The Licensee, that is the person in whose name the premises licence is issued, shall ensure that all times when the premises are for any licensable activity, there are sufficient competent staff on duty at the premises for the purpose of fulfilling the terms and conditions of the licence and for preventing crime and disorder. The Licensee shall ensure that all staff will undertake training in their responsibilities in relation to the sale of alcohol, particularly with regard to drunkenness and underage persons. Records will be kept of training and refresher training.

b) The prevention of crime and disorder

Any incidents of a criminal nature that may occur on the premises will be reported to the Police.

The Licensee will install comprehensive CCTV coverage at the premises and it is operated and maintained at the premises.

The CCTV system shall conform to the following points:

1. Cameras must be sited to observe the entrance and exit doors both inside and outside.
2. Cameras on the entrances must capture full frame shots of the heads and shoulders of all people entering the premises i.e. capable of identification.
3. Cameras viewing till areas must capture frames not less than 50% of screen.
4. Cameras overlooking floor areas should be wide angled to give an overview of the premises.
5. Be capable of visually confirming the nature of the crime committed.
6. Provide a linked record of the date, time and place of any image.
7. Provide good quality images –colour during opening times.
8. Operate under existing light levels within and outside the premises.
9. Have the recording device located in a secure area or locked cabinet.
10. Have a monitor to review images and recorded picture quality.
11. Be regularly maintained to ensure continuous quality of image capture retention.
12. Have signage displayed in the customer area to advise that CCTV is in operation.
13. Digital images must be kept for 31 days.
14. Police will have access to images at any reasonable time.
15. The equipment must have a suitable export method, e. G. CD/DVD writer so that the police can make an evidential copy of the data they require. This data should be in the native file format, to ensure that no image quality is lost when making the copy, if this format is non-standard (i.e. manufacturer proprietary) then the manufacturer should supply the replay software to ensure that the video on the CD can be replayed by the police on a standard computer. Copies must be made available to Police on request.

c) Public safety

Appropriate fire safety procedures are in place including fire extinguishers (foam, H2O and CO2), fire blanket, internally illuminated fire exit signs, numerous smoke detectors and emergency lighting (see enclosed plan for details of locations). All appliances are inspected annually. All emergency exits shall be kept free from obstruction at all times.

d) The prevention of public nuisance

All customers will be asked to leave quietly. Clear and legible notices will be prominently displayed to remind customers to leave quietly and have regard to our neighbours.

e) The protection of children from harm

The licensee and staff will ask persons who appear to be under the age of 25 for photographic ID such as proof of age cards, the Connexions Card and Citizen Card, photographic driving licence or passport, an official identity card issued by HM Forces or by an EU country, bearing the photograph and date of birth of bearer. All staff will be trained for underage sales prevention regularly. A register of refused sales shall be kept and maintained on the premises.

Checklist:

Please tick to indicate agreement

- I have made or enclosed payment of the fee.
- I have enclosed the plan of the premises.
- I have sent copies of this application and the plan to responsible authorities and others where applicable.
- I have enclosed the consent form completed by the individual I wish to be designated premises supervisor, if applicable.
- I understand that I must now advertise my application.

- I understand that if I do not comply with the above requirements my application will be rejected.

- [Applicable to all individual applicants, including those in a partnership which is not a limited liability partnership, but not companies or limited liability partnerships] I have included documents demonstrating my entitlement to work in the United Kingdom or my share code issued by the Home Office online right to work checking service (please read note 15).

IT IS AN OFFENCE, UNDER SECTION 158 OF THE LICENSING ACT 2003, TO MAKE A FALSE STATEMENT IN OR IN CONNECTION WITH THIS APPLICATION. THOSE WHO MAKE A FALSE STATEMENT MAY BE LIABLE ON SUMMARY CONVICTION TO A FINE OF ANY AMOUNT.

IT IS AN OFFENCE UNDER SECTION 24B OF THE IMMIGRATION ACT 1971 FOR A PERSON TO WORK WHEN THEY KNOW, OR HAVE REASONABLE CAUSE TO BELIEVE, THAT THEY ARE DISQUALIFIED FROM DOING SO BY REASON OF THEIR IMMIGRATION STATUS. THOSE WHO EMPLOY AN ADULT WITHOUT LEAVE OR WHO IS SUBJECT TO CONDITIONS AS TO EMPLOYMENT WILL BE LIABLE TO A CIVIL PENALTY UNDER SECTION 15 OF THE IMMIGRATION, ASYLUM AND NATIONALITY ACT 2006 AND PURSUANT TO SECTION 21 OF THE SAME ACT, WILL BE COMMITTING AN OFFENCE WHERE THEY DO SO IN THE KNOWLEDGE, OR WITH REASONABLE CAUSE TO BELIEVE, THAT THE EMPLOYEE IS DISQUALIFIED.

Part 4 – Signatures (please read guidance note 11)

Signature of applicant or applicant’s solicitor or other duly authorised agent (see guidance note 12). **If signing on behalf of the applicant, please state in what capacity.**

Declaration	<ul style="list-style-type: none"> [Applicable to individual applicants only, including those in a partnership which is not a limited liability partnership] I understand I am not entitled to be issued with a licence if I do not have the entitlement to live and work in the UK (or if I am subject to a condition preventing me from doing work relating to the carrying on of a licensable activity) and that my licence will become invalid if I cease to be entitled to live and work in the UK (please read guidance note 15). The DPS named in this application form is entitled to work in the UK (and is not subject to conditions preventing him or her from doing work relating to a licensable activity) and I have seen a copy of his or her proof of entitlement to work, or have conducted an online right to work check using the Home Office right to work checking service which confirmed their right to work (please see note 15)
Signature	JACEK BILINSKI
Date	21/2/2020
Capacity	APPLICANT

For joint applications, signature of 2nd applicant or 2nd applicant’s solicitor or other authorised agent (please read guidance note 13). **If signing on behalf of the applicant, please state in what capacity.**

Signature	
-----------	--

Date	21/2/2020
Capacity	

Contact name (where not previously given) and postal address for correspondence associated with this application (please read guidance note 14)			
████████████████████ ████████████████████ ████████████████████ ██████████			
Post town	██████████	Postcode	██████████
Telephone number (if any)	██████████		
If you would prefer us to correspond with you by e-mail, your e-mail address (optional)			
████████████████████			

Notes for Guidance

1. Describe the premises, for example the type of premises, its general situation and layout and any other information which could be relevant to the licensing objectives. Where your application includes off-supplies of alcohol and you intend to provide a place for consumption of these off-supplies, you must include a description of where the place will be and its proximity to the premises.
2. In terms of specific regulated entertainments please note that:
 - Plays: no licence is required for performances between 08:00 and 23.00 on any day, provided that the audience does not exceed 500.
 - Films: no licence is required for ‘not-for-profit’ film exhibition held in community premises between 08.00 and 23.00 on any day provided that the audience does not exceed 500 and the organiser (a) gets consent to the screening from a person who is responsible for the premises; and (b) ensures that each such screening abides by age classification ratings.
 - Indoor sporting events: no licence is required for performances between 08.00 and 23.00 on any day, provided that the audience does not exceed 1000.
 - Boxing or Wrestling Entertainment: no licence is required for a contest, exhibition or display of Greco-Roman wrestling, or freestyle wrestling between 08.00 and 23.00 on any day, provided that the audience does not exceed 1000. Combined fighting sports – defined as a contest, exhibition or display which combines boxing or wrestling with one or more martial arts – are licensable as a boxing or wrestling entertainment rather than an indoor sporting event.
 - Live music: no licence permission is required for:

Notes:
 1. THE COPYRIGHT OF THIS DRAWING IS RESERVED IN YOUR OWNERSHIP AND IT MAY NOT BE REPRODUCED IN WHOLE OR PART OR USED IN THE MANUFACTURE OF ANY ARTICLE WITHOUT THE EXPRESS WRITTEN PERMISSION OF THE ARCHITECT.
 2. WORK TO FIGURED DIMENSIONS ONLY.
 3. THIS DRAWING IS TO BE READ IN CONJUNCTION WITH ALL RELEVANT ARCHITECT'S, SERVICE ENGINEERS AND YourSpreadsheets DRAWING AND SPECIFICATIONS.

- KEY:
- SL SAFETY LIGHT
 - S SMOKE DETECTOR
 - FE FIRE EXTINGUISHER
 - BG BREAK GLASS
 - △ CCTV CAMERA
 - △ ALARM SENSOR PLACEMENT

GROUND FLOOR

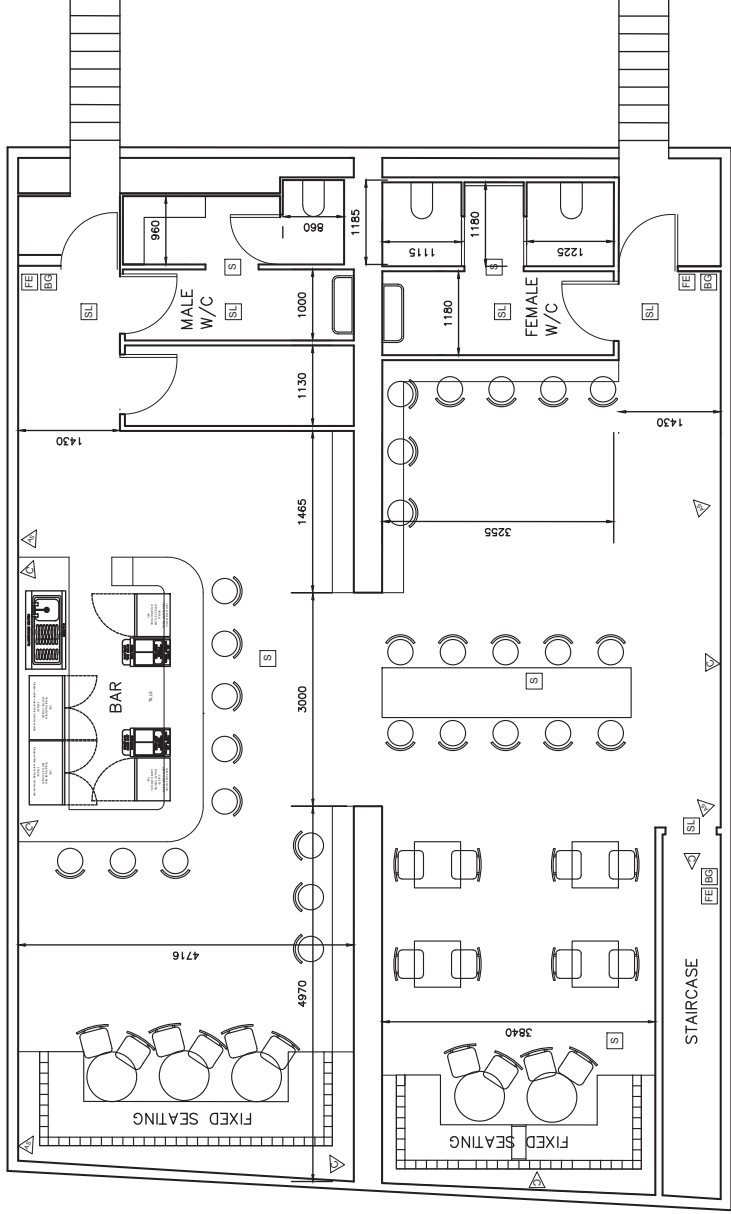
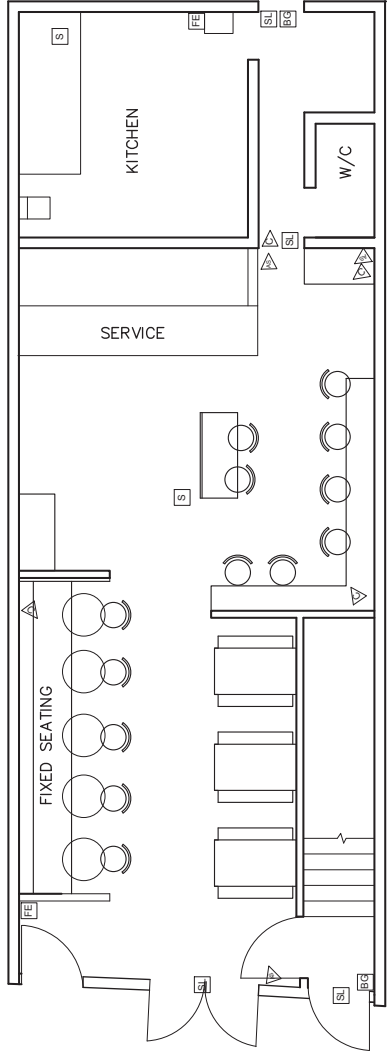

BASEMENT

REV:	DESCRIPTION:	BY:	DATE:
	DESIGN INTENT		
Uprooted Studio			
CLIENT:	FANNY'S BASEMENT LONDON		
DESIGNER:	Uprooted Studio 51 Parsons Green Lane London SW6 4JA		
SITE:	FANNY'S BASEMENT		
TITLE:	FIRE AND SECURITY PLAN		
SCALE AT A3:	DATE:	DRAWN:	CHECKED:
1:50	06/03/18	TC	TC
PROJECT NO.:	DRAWING NO.:	REVISION:	
10007	A3/248	A	

APPENDIX B

RESPONSIBLE AUTHORITY REPRESENTATION: APPLICATION UNDER THE LICENSING ACT 2003

RESPONSIBLE AUTHORITY DETAILS

NAME OF AUTHORITY	Metropolitan Police service
ADDRESS OF AUTHORITY	Licensing Unit, Stoke Newington Police Station 33 Stoke Newington High Street London N16 8DS
CONTACT NAME	PC 1505CE Dave ATKINS
TELEPHONE NUMBER	020 7275 3022
E-MAIL ADDRESS	hackneylicensing@met.police.uk

APPLICATION PREMISES

NAME & ADDRESS OF PREMISES	Fanny's Kebabs Basement and Ground Floor 92 Stoke Newington High Street N16 7NY
NAME OF PREMISES USER	Jacek Bilinski

COMMENTS

I make the following relevant representations in relation to the above application to vary the Premises Licence at the above address.

- 1) The prevention of crime and disorder ◆
- 2) Public safety ◆
- 3) The prevention of public nuisance ◆
- 4) The protection of children from harm

Representations (which include comments and/or objections) in relation to:

Police make the following representations in relation to the new premises licence at 92 Stoke Newington High Street, n16 7NY.

This premises is a kebab shop requesting supply of alcohol licensable activities Sunday to Wednesday 1000hours – 2345hours, Thursdays 1000hours – 0100hours and Fridays and Saturdays 1000hours – 0130hours. The opening hours on Sunday to Wednesday cease fifteen minutes after licensable activities and alongside those of the licensable activity on Thursday, Friday and Saturday

The venue is situated on a one way road and is among a gallery of shops with residential premises above

The venue is currently operating under an existing licence (090237).

The applied for hours in this application sit outside those core hours as detailed in the LP3 of the London Borough of Hackneys statement of Licensing policy, a policy that the applicant has failed to mention that they are aware of. It is worth noting at this time that the venue is currently operating an existing premises licence that already benefits from hours exceeding those in the policy Sunday through to Thursday

Whilst on occasion the venue has been operating till later hours on Temporary event notices it is the concern of police that should the venue have a licence allowing the it to operate later hours on a regular basis this will affect the quality of life for local residents and have an impact on the public nuisance objective. Police would ask the applicant what steps they intend to take in order to minimise any such impact as the operating schedules offers far less than those steps that currently being undertaken as per the conditions on the current licence.

If this licence is granted police would request that the Current licence (090237) is surrendered.

Police look forward to hearing from the applicant to discuss theses representations.

The above representations are supported by the following evidence and information.

Are there any actions or measures that could be taken to allay concerns or objections? If so, please explain.

Signed PC 1505CE ATKINS (By E-mail)
Name (printed)



This premises licence has been issued by:

Licensing Service
1 Hillman Street
London E8 1DY

PART A – PREMISES LICENCE

Premises Licence Number

090237

Part 1 – Premises details

Fanny's Kebabs
Ground Floor & Lower Ground Floor
92 Stoke Newington High Street
Hackney
London
N16 7NY

Where the licence is time limited the dates

Not Applicable

Licensable activities authorised by the licence

Plays
Films
Live Music
Recorded Music
Performance of Dance
Other Entertainment Similar to Live or Rec Music or Dance Performance
Late Night Refreshment
Supply of Alcohol

The times the licence authorises the carrying out of licensable activities

Plays

Standard Hours:

INDOOR:

Mon 10:00-23:45
Tue 10:00-23:45
Wed 10:00-23:45
Thu 10:00-23:45
Fri 10:00-23:45
Sat 10:00-23:45
Sun 10:00-23:45

Films **Standard Hours:**

INDOOR: Mon 10:00-23:45
Tue 10:00-23:45
Wed 10:00-23:45
Thu 10:00-23:45
Fri 10:00-23:45
Sat 10:00-23:45
Sun 10:00-23:45

Live Music **Standard Hours:**

INDOOR: Mon 10:00-23:45
Tue 10:00-23:45
Wed 10:00-23:45
Thu 10:00-23:45
Fri 10:00-23:45
Sat 10:00-23:45
Sun 10:00-23:45

Recorded Music **Standard Hours:**

INDOOR: Mon 10:00-23:45
Tue 10:00-23:45
Wed 10:00-23:45
Thu 10:00-23:45
Fri 10:00-23:45
Sat 10:00-23:45
Sun 10:00-23:45

Performance of Dance **Standard Hours:**

INDOOR: Mon 10:00-23:45
Tue 10:00-23:45
Wed 10:00-23:45
Thu 10:00-23:45
Fri 10:00-23:45
Sat 10:00-23:45
Sun 10:00-23:45

Other Entertainment Similar to Live or Rec Music or Dance Performance **Standard Hours:**

INDOOR: Mon 10:00-23:45
Tue 10:00-23:45
Wed 10:00-23:45
Thu 10:00-23:45
Fri 10:00-23:45
Sat 10:00-23:45
Sun 10:00-23:45

Late Night Refreshment

Standard Hours:

INDOOR:

Mon 23:00-23:45
Tue 23:00-23:45
Wed 23:00-23:45
Thu 23:00-23:45
Fri 23:00-23:45
Sat 23:00-23:45
Sun 23:00-23:45

Supply of Alcohol

Standard Hours:

INDOOR:

Mon 10:00-23:30
Tue 10:00-23:30
Wed 10:00-23:30
Thu 10:00-23:30
Fri 10:00-23:30
Sat 10:00-23:30
Sun 10:00-23:30

The opening hours of the premises

Standard Hours:

Mon 10:00-00:00
Tue 10:00-00:00
Wed 10:00-00:00
Thu 10:00-00:00
Fri 10:00-00:00
Sat 10:00-00:00
Sun 10:00-00:00

Where the licence authorises supplies of alcohol whether these are on and/or off supplies

On and Off Premises

Part 2 –

Name, (registered) address, telephone number and e-mail (where relevant) of holder of premises licence

Posh Kebabs London Ltd
22 Waterford Road
London
SW6 2DR

Registered number of holder, for example company number, charity number (where applicable)

10381905

Name, address and telephone number of designated premises supervisor where the premises authorises the supply of alcohol

Jacek Bilinski

Personal licence number and issuing authority of personal licence held by designated premises supervisor where the premises licence authorises the supply of alcohol

Date of Grant: 1 November 2017

Signed:

**David Tuitt
Team Leader - Licensing**

Annex 1 - Mandatory Conditions

Supply of Alcohol

1. No supply of alcohol may be made under the premises licence:
 - (a) At a time when there is no designated premises supervisor in respect of the premises licence.
 - (b) At a time when the designated premises supervisor does not hold a personal licence or his personal licence is suspended.
2. Every supply of alcohol under the premises licence must be made or authorised by a person who holds a personal licence.
3.
 - (1) The responsible person must ensure that staff on relevant premises do not carry out, arrange or participate in any irresponsible promotions in relation to the premises.
 - (2) In this paragraph, an irresponsible promotion means any one or more of the following activities, or substantially similar activities, carried on for the purpose of encouraging the sale or supply of alcohol for consumption on the premises -
 - (a) games or other activities which require or encourage, or are designed to require or encourage, individuals to;
 - (i) drink a quantity of alcohol within a time limit (other than to drink alcohol sold or supplied on the premises before the cessation of the period in which the responsible person is authorised to sell or supply alcohol), or
 - (ii) drink as much alcohol as possible (whether within a time limit or otherwise);
 - (b) provision of unlimited or unspecified quantities of alcohol free or for a fixed or discounted fee to the public or to a group defined by a particular characteristic in a manner which carries a significant risk of undermining a licensing objective;
 - (c) provision of free or discounted alcohol or any other thing as a prize to encourage or reward the purchase and consumption of alcohol over a period of 24 hours or less in a manner which carries a significant risk of undermining a licensing objective;
 - (d) selling or supplying alcohol in association with promotional posters or flyers on, or in the vicinity of, the premises which can reasonably be considered to condone, encourage or glamorise anti-social behaviour or to refer to the effects of drunkenness in any favourable manner.
 - (e) dispensing alcohol directly by one person into the mouth of another (other than where that other person is unable to drink without assistance by reason of a disability).
4. The responsible person must ensure that free potable water is provided on request to customers where it is reasonably available.

5. 5.1. The premises licence holder or club premises certificate holder must ensure that an age verification policy is adopted in respect of the premises in relation to the sales or supply of alcohol.
- 5.2. The designated premises supervisor in relation to the premises licences must ensure that the supply of alcohol at the premises is carried on in accordance with the age verification policy.
- 5.3. The policy must require individuals who appear to the responsible person to be under 18 years of age (or such older age as may be specified in the policy) to produce on request, before being served alcohol, identification bearing their photograph, date of birth and either:-
- (a) a holographic mark or
 - (b) an ultraviolet feature
6. The responsible person must ensure that:
- a) where any of the following alcoholic drinks is sold or supplied for consumption on the premises (other than alcoholic drinks sold or supplied having been made up in advance ready for sale or supply in a securely closed container) it is available to customers in the following measures:
 - beer or cider: 1/2 pint;
 - gin, rum, vodka or whisky: 25ml or 35ml; and
 - still wine in a glass: 125ml; and
 - b) these measures are displayed in a menu, price list or other printed material which is available to customers on the premises; and
 - c) where a customer does not in relation to a sale of alcohol specify the quantity of alcohol to be sold, the customer is made aware that these measures are available.

Minimum Drinks Pricing

7. 7.1 A relevant person shall ensure that no alcohol is sold or supplied for consumption on or off the premises for a price which is less than the permitted price.
- 7.2. For the purposes of the condition set out in paragraph 7.1 above -
- (a) "duty" is to be construed in accordance with the Alcoholic Liquor Duties Act 1979;
 - (b) "permitted price" is the price found by applying the formula - $P = D + (D \times V)$
Where -
 - (i) P is the permitted price,
 - (ii) D is the rate of duty chargeable in relation to the alcohol as if the duty were charged on the date of the sale or supply of the alcohol, and
 - (iii) V is the rate of value added tax chargeable in relation to the alcohol as if the value added tax were charged on the date of the sale or supply of the alcohol;

- (c) "relevant person" means, in relation to premises in respect of which there is in force a premises licence -
- (i) the holder of the premises licence,
 - (ii) the designated premises supervisor (if any) in respect of such a licence, or
 - (iii) the personal licence holder who makes or authorises a supply of alcohol under such a licence;
- (d) "relevant person" means, in relation to premises in respect of which there is in force a club premises certificate, any member or officer of the club present on the premises in a capacity which enables the member or officer to prevent the supply in question; and
- (e) "value added tax" means value added tax charged in accordance with the Value Added Tax Act 1994.

7.3 Where the permitted price given by Paragraph 7.2(b) above would (apart from this paragraph) not be a whole number of pennies, the price given by that sub-paragraph shall be taken to be the price actually given by that sub-paragraph rounded up to the nearest penny.

7.4 (1) Sub-paragraph 7.4(2) below applies where the permitted price given by Paragraph 7.2(b) above on a day ("the first day") would be different from the permitted price on the next day ("the second day") as a result of a change to the rate of duty or value added tax.

(2) The permitted price which would apply on the first day applies to sales or supplies of alcohol which take place before the expiry of the period of 14 days beginning on the second day.

Exhibition Of Films

8. Admission of children (under 18) to the exhibition of any film must be restricted in accordance with: -
- (a) Recommendations made by the film classification body where the film classification body is specified in the licence, or
 - (b) Recommendations made by the licensing authority where the film classification body is not specified in the licence, or the relevant licensing authority has not notified the holder of the licence that this subsection applies to the film in question.

"film classification body" means person('s) designated under s4 of the Video Recordings Act 1984(c.39).

Door Supervision

9. Each individual who is to carry out a security activity at the premises must be licensed by the Security Industry Authority.

Annex 2 – Conditions consistent with the Operating Schedule

10. The premises shall install and maintain a comprehensive CCTV system as per the minimum requirements of a Metropolitan Police Crime Prevention Officer. All entry and exit points will be covered enabling frontal identification of every person entering in any light condition. The CCTV system shall continually record whilst the premises is open for licensable activities and during all times when customers remain on the premises. All recordings shall be stored for a minimum period of 31 days with date and time stamping. Recordings shall be made available immediately upon the request of Police or authorised officer throughout the preceding 31-day period.
11. A staff member from the premises who is conversant with the operation of the CCTV system shall be on the premises at all times when the premises are open to the public. This staff member must be able to show a Police or authorised council officer recent data or footage when requested.
12. SIA qualified door supervisors shall be present on Thursday to Saturdays from 2200 Hours if the basement is in use. SIA registered door supervisors will be considered continually as part of an ongoing operational risk assessment at all other times. All door supervisors shall enter their full details in the premises daily register at the commencement of their work. They shall record their full name, company address and contact telephone number, their SIA registration number, and the time they commence and conclude working. If the door supervisor was provided by an agency the name, registered business address and contact telephone number will also be recorded. This register will be made available to police or authorised officer immediately upon request.
13. Door supervisors engaged in duties outside shall wear a high visibility vest or jacket so that they are clearly identifiable.
14. All persons entering the venue will be counted in and out by a member of SIA door staff using mechanical 'clicker' devices. These will be supplied by the venue.
15. Signs will be prominently displayed at all exit points reminding customers to leave quietly and respect local residents.
16. The premises will have a venue management policy, approved by the police licensing officer and/or Crime prevention officer, detailing the following;
 - a. Entry and search policy
 - b. Drugs Policy, which shall include Hackney Police local Policy 2014 (or as amended)
 - c. Queuing and dispersal policy
 - d. Security Policy
 - e. Noise Policy
 - f. Smoking Policy
 - g. Alcohol Policy

- h. Theft Reduction Policy, as per Hackney Police Local Policy 2014 (or as amended)
17. Any queues to enter the venue will be supervised by the door supervisor.
 18. A Challenge 25 proof of age scheme shall be operated at the premises where the only acceptable forms of identification are recognised photographic identification cards, such as driving licence or passport.
 19. An incident log shall be kept at the premises, and made available on request to an authorised officer of the council or the police, which will record the following.
 - a. All crimes reported:
 - b. All ejections of patrons
 - c. Any complaints received.
 - d. Any incidents of disorder.
 - e. Seizure of drugs or offensive weapons.
 - f. Any faults in the CCTV system or searching equipment or scanning equipment. Any refusal of the sale of alcohol.
 - g. Any visit by a relevant authority or emergency service.
 20. Signs will be prominently displayed by entry and exit points reminding customs:
 - a. CCTV in operation.
 - b. Drugs policy.
 - c. Weapons policy.
 - d. To leave quietly and respect local residents.
 21. All staff will be given refresher training every twelve months on the legislation relating to the sales of alcohol to underage persons and drunken persons.
 22. The licence holder shall maintain a dedicated telephone number of the Designated Premises Supervisor for use by any Responsible Authority or any person who may wish to make a complaint. This contact number shall be provided to licensing authority, police and to any local residents upon request.
 23. Patrons will not be allowed to take open containers outside of the premises at any time.
 24. The Licensee shall ensure that all staff are fully trained and made aware of the legal requirement of businesses to comply with their duty of care as regards the disposal of waste produced from the business premises. The procedure for handling and preparing for disposal of the waste shall be in writing and displayed in a prominent place where it can be referred to at all times by staff.
 25. The Licensee shall ensure that any contract for general and recyclable waste disposal shall be appropriate in size to the amount of waste produced by the business. The Licensee shall maintain an adequate supply of waste receptacles provided by his registered waste carrier (refuse sacks or

commercial waste bins) in order to ensure all refuse emanating from the business is always presented for collection by his waste carrier and shall not use any plain black or unidentifiable refuse sacks or any other unidentifiable or unmarked waste receptacles.

26. The Licensee's premises are situated in an area within which refuse may only be left on the public highway at certain times (time bands). If the Licensee's waste carrier cannot or does not comply by collecting the refuse within an hour after the close of any time band imposed by the waste authority, the Licensee must remove the refuse from the public highway and/or keep it within the premises until such time as his waste carrier arrives to collect the refuse.
27. The Licensee shall provide a safe receptacle for cigarette ends to be placed outside for the use of customers, such receptacle being carefully placed so as not to cause an obstruction or trip.
28. All amplified recorded and live music played within the premises, shall be subject to the control of noise limiter so noise and vibration is inaudible in the nearest noise sensitive premises between the hours of 23:00 and 07:00 on any day and does not cause nuisance at all other times anytime.
29. The licensee shall submit to the Council an acoustic report prepared by a reputable noise consultant (who is a member of the Institute of Acoustics or similar recognised association), which demonstrates how live music and amplified sound and voices generated at the premises will be contained within the said premises, thereby not causing a disturbance to neighbouring premises. The report shall have regard to any noise caused by any ventilation system and any likely escape of noise from the system, the opening of doors for patrons, acoustic characteristics of fire doors, windows, and the General fabric of the building. Where sound transmission is likely through the structure of the building to one attached the report must show in detail how this will be eradicated.
30. The report should also include details of how smoking, patrons queuing or congregating outside will be managed.
31. The report is to be submitted to the Community Safety Team for their approval. All recommendations within the report which have been approved by the Community Safety Team should be completed prior to the grant of the premises licence.
32. A suitable sound limiting device (s) must be installed to all systems generating music and/or amplified voices. The limiting device (s) should be set to ensure inaudibility in a nearest residential premises, a certificate of compliance should be submitted to the Pollution Control Team for their approval. The limiter (s) should be protected in such a manner as to prevent tampering with (i.e. locked in a tamper - proof box and only accessible by management or / and protected by password). The sound limiting device shall be used at all times when regulated entertainment is taking place.

33. Any entertainment involving live and / or recorded music can only take place if conditions 28 to 32 will be implemented to the satisfaction of the Community Safety Team.
34. Live music should be restricted to the basement area only.
35. Notices must be prominently displayed at the exits reminding patrons to depart in an orderly manner.
36. All speakers must be isolated from the structure of the building by using anti vibration foam, mat, or ant vibration mounts.
37. On the ground floor, alcohol shall not be sold, supplied or consumed otherwise than to persons who are taking a substantial meal from the menu and that the consumption of intoxicating liquor by such persons in ancillary to taking such meals, save for 6 people who are waiting to be seated. All customers shall be seated and served at the table by waiter/waitress service only.
38. There shall be a minimum of 40 seats set out in the basement at all times.
39. There shall be no more than 8 people allowed to smoke outside the venue at any one time.
40. Customers will not have access to the rear alleyway behind the venue, except in emergencies.
41. Alcohol can only be delivered to a residential or business address and not to a public place. Delivery staff will not deliver to any person anywhere other than at the residential / business address given when the order was placed.

Annex 3 – Conditions attached after a hearing by the licensing authority

Not applicable

Annex 4 – Plans

PLAN/090237/080618

Notes:

1. THE COPYRIGHT OF THIS DRAWING IS RESERVED IN YOUR OWNERSHIP AND IT MAY NOT BE REPRODUCED IN WHOLE OR PART OR USED FOR THE MANUFACTURE OF ANY ARTICLE WITHOUT THE EXPRESS WRITTEN PERMISSION OF THE ARCHITECT.
2. WORK TO FIGURED DIMENSIONS ONLY.
3. THIS DRAWING IS TO BE READ IN CONJUNCTION WITH ALL RELEVANT ARCHITECT'S, SERVICE ENGINEERS' AND YOURSPREADSHEETS DRAWING AND SPECIFICATIONS.

KEY:

- SL SAFETY LIGHT
- S SMOKE DETECTOR
- FE FIRE EXTINGUISHER
- BG BREAK GLASS
- CAM CCTV CAMERA
- AS ALARM SENSOR PLACEMENT

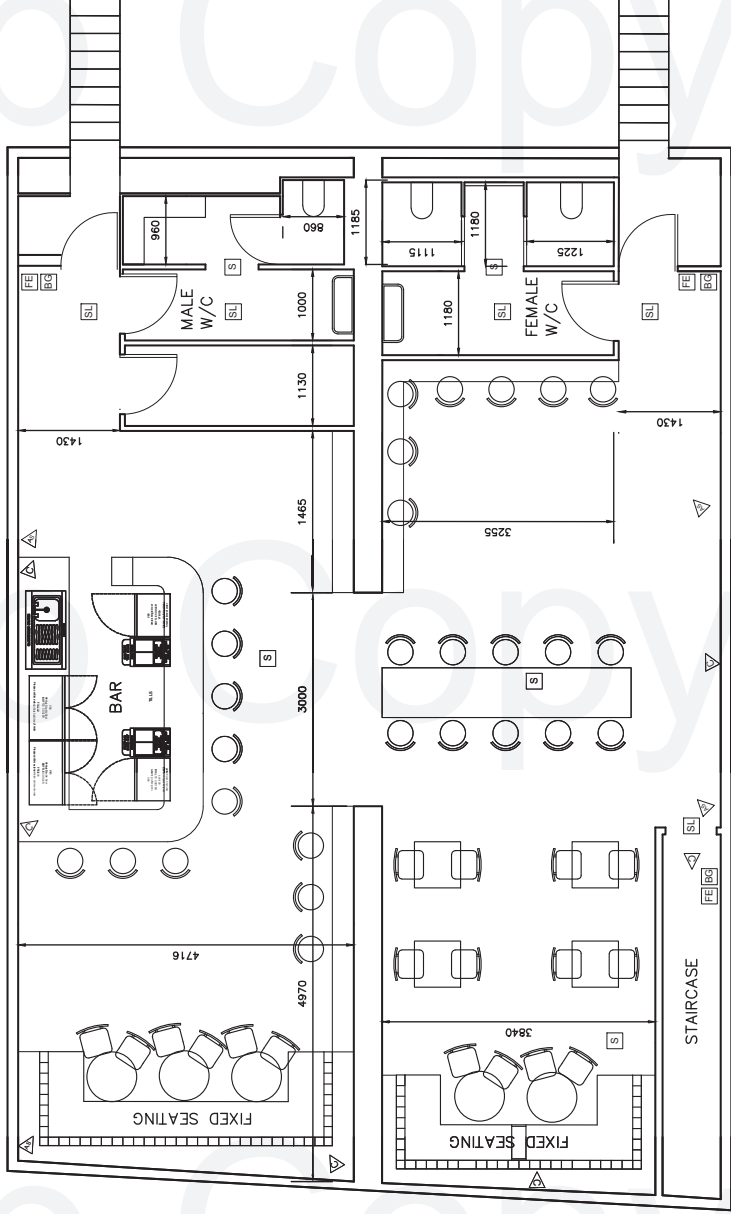
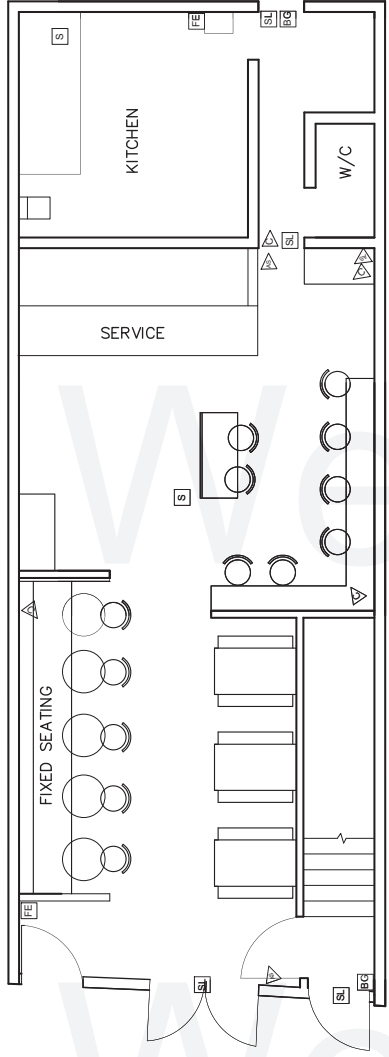

REV:	DESCRIPTION:	BY:	DATE:
	DESIGN INTENT		

Uprooted Studio

CLIENT: FANNY'S BASEMENT
LONDON

DESIGNER: Uprooted Studio
51 Parsons Green Lane
London
SW6 4JA

SITE: FANNY'S BASEMENT

TITLE: FIRE AND SECURITY PLAN

SCALE AT A3:	DATE:	DRAWN:	CHECKED:
1:50	06/03/18	TC	TC
PROJECT NO.:	DRAWING NO.:	REVISION:	
10007	A3/248	A	

APPENDIX D

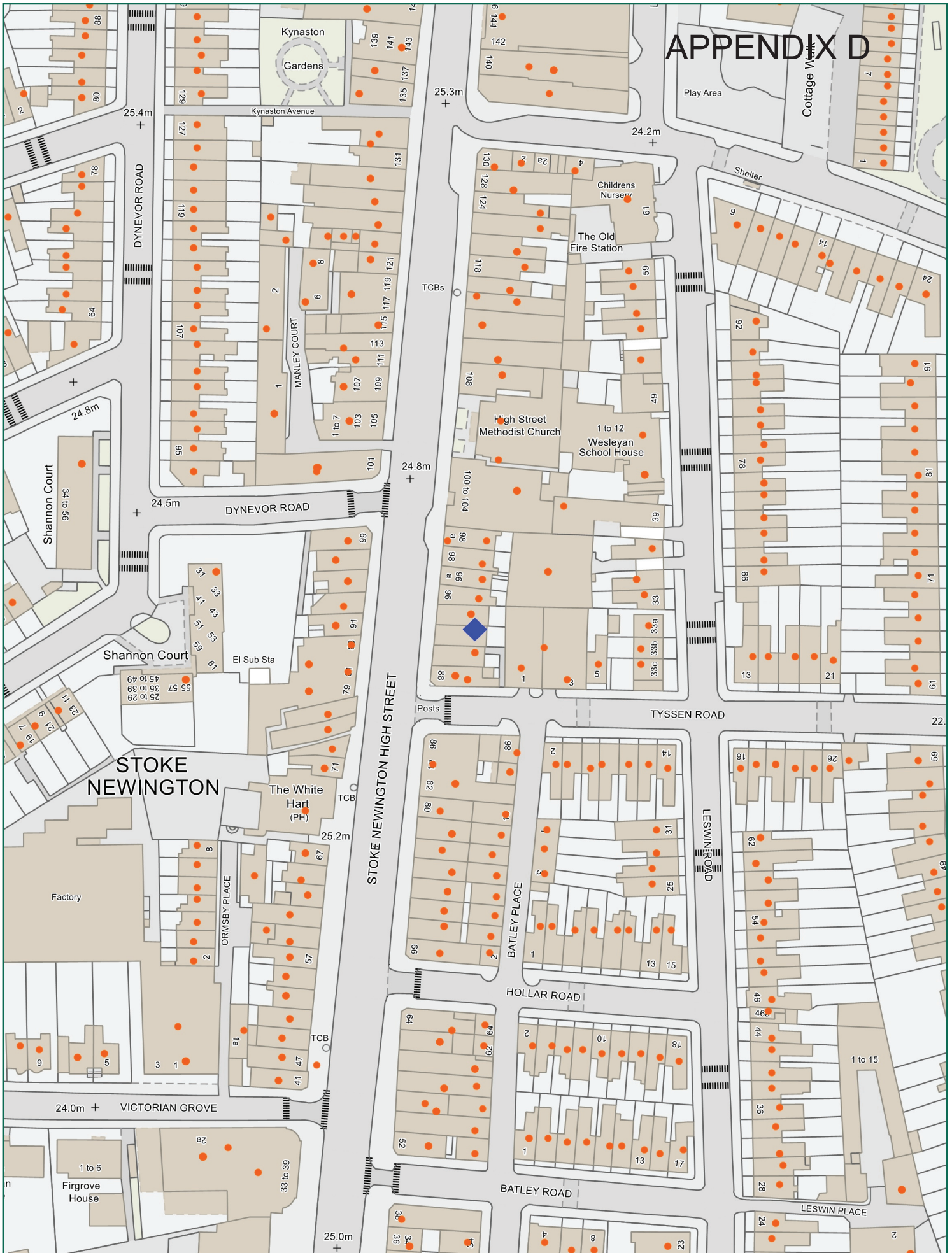

Scale: 1:1250 at A4

Fanny's Kebabs, 92 Stoke Newington High Street, N16 7NY



Ref:

Produced by: unspecified

please specify copyright statement

01 April 2020

email: